

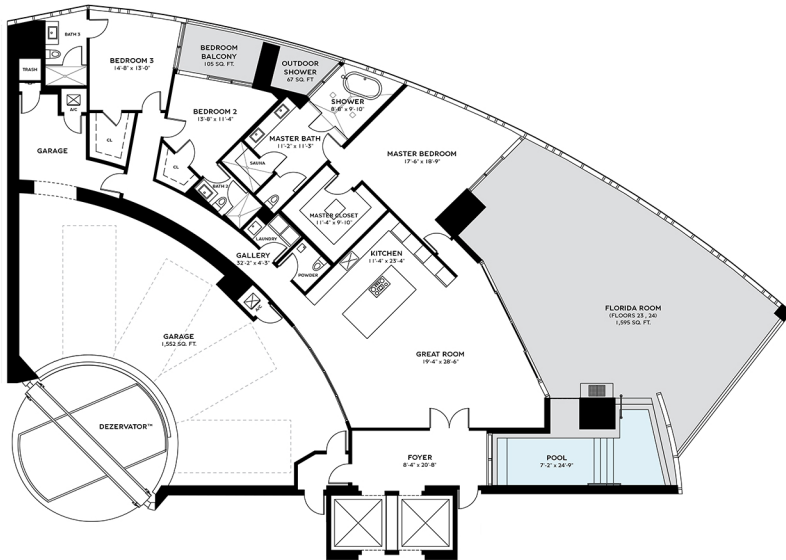

**BENTLEY  
RESIDENCES**



**RESIDENCE ARNAGE**

**3 BEDS | 3.5 BATHS**

FLOORS 23, 24

INTERIOR	3,014 SQ. FT.	919 SQ. M.
BALCONY	1,767 SQ. FT.	558 SQ. M.
GARAGE	1,552 SQ. FT.	473 SQ. M.
<b>TOTAL</b>	<b>6,333 SQ. FT.</b>	<b>1,930 SQ. M.</b>

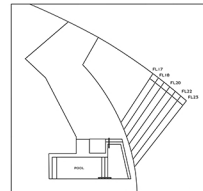
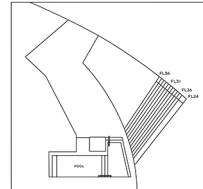

TERRACE AREA VARIES BY FLOOR

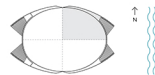

ORAL REPRESENTATIONS CANNOT BE RELIED UPON AS CORRECTLY STATING THE REPRESENTATIONS OF THE DEVELOPER. FOR CORRECT REPRESENTATIONS, PLEASE REFERENCE TO THIS BROCHURE AND TO THE DOCUMENTS REQUIRED BY SECTION 718.05, FLORIDA STATUTES, TO BE FURNISHED BY A DEVELOPER TO A BUYER OR LESSEE.  
 General square footages and dimensions are provided to the best knowledge of the creator, with and to the best of the creator's ability, and are not intended to constitute any warranty, express or implied, of accuracy or completeness. This brochure is generally used to solicit interest and to provide a general overview of the project. It is not intended to constitute an offer of any real estate. All dimensions are approximate and may vary without notice. Measurements of rooms on this floor plan are given by the finished points of each given room (i.e. if the room uses a garden rectangle, without regard for any columns or columns). Accordingly, the area of the actual room will typically be smaller than the product

obtained by multiplying the stated length and width. All dimensions are approximate which will vary with actual construction, and all floor plans, specifications and other development plans are subject to change and will not necessarily accurately reflect the final plans and specifications for the development. All depictions of appliances, cabinets, sofas, floor coverings and other matters of detail, including, without limitation, items of finish and decoration, are conceptual only and are not necessarily included in each unit.

BY DEZER