

RESIDENCE C

4 BEDROOMS / 5.5 BATH
FAMILY ROOM & IRONING ROOM

INDOOR LIVING AREA	6,225 sq ft	578.3 sq m
OUTDOOR LIVING AREA	1,305 sq ft	121.2 sq m
<hr/>		
TOTAL LIVING AREA	7,530 sq ft	699.5 sq m
<hr/>		
PAINT -TO-PAINT AREA	5,717 sq ft	531.1 sq m

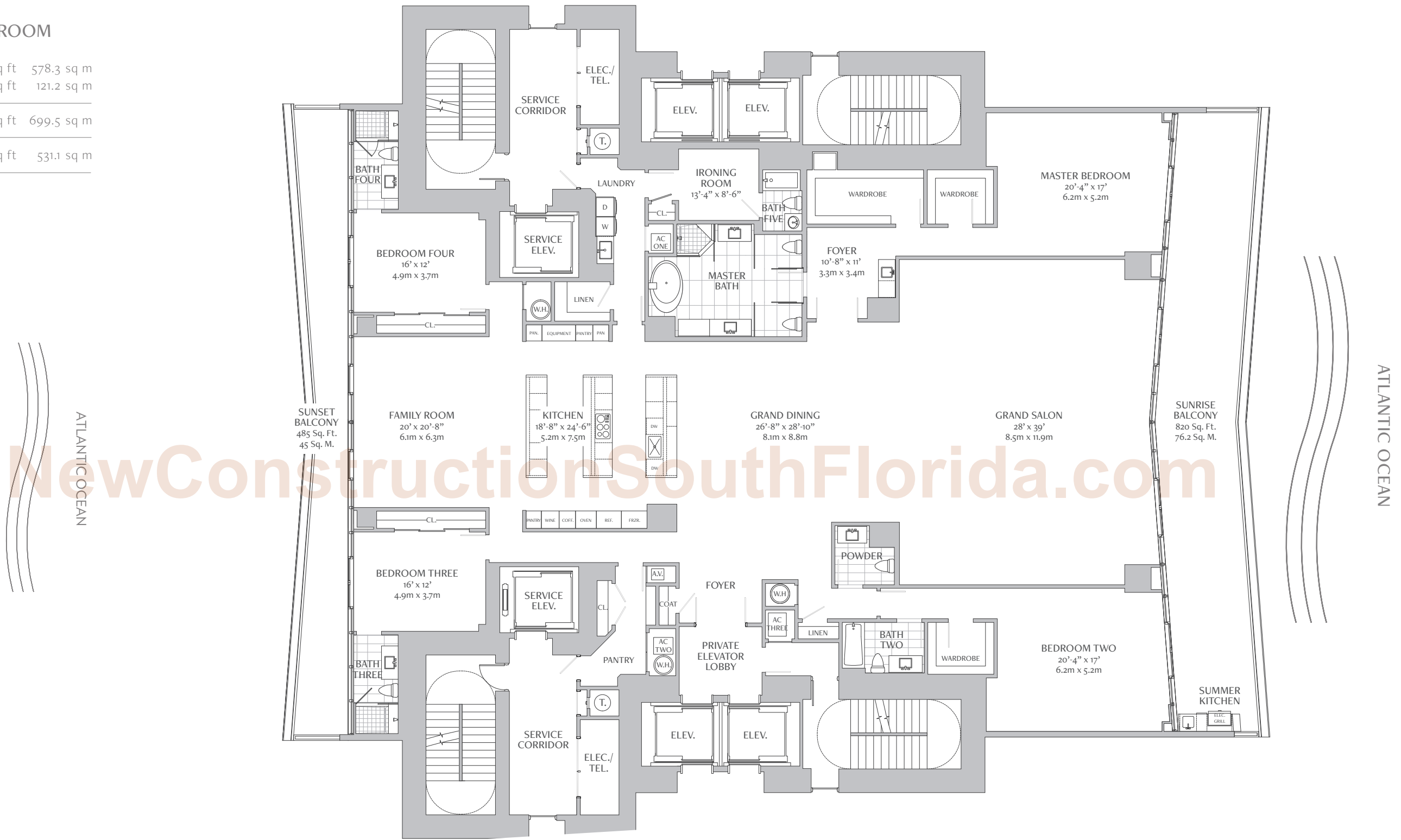
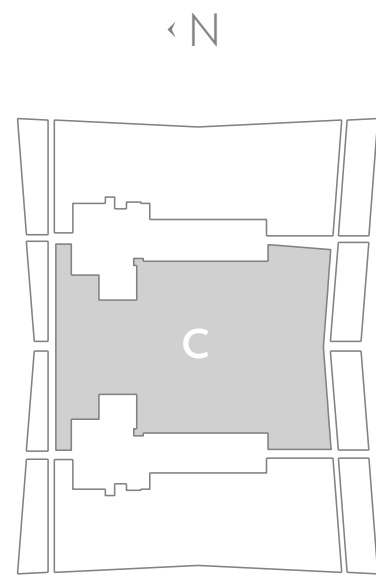

NewConstructionSouthFlorida.com

SUBJECT TO ARCHITECTURAL AND OTHER REVISIONS AT THE SOLE DISCRETION OF THE DEVELOPER, BUILDER OR ARCHITECT, THIS FLOOR PLAN MAY NOT BE TO SCALE. ANY FURNITURE, APPLIANCES OR DECORATOR READY ITEMS DEPICTED HEREIN ARE SHOWN FOR REPRESENTATION ONLY AND ARE NOT INCLUDED IN THE PURCHASE AND SALE OF THE RESIDENCE. STATED DIMENSIONS ARE MEASURED TO THE EXTERIOR FINISH LINE OF THE INTERIOR DEMISING WALLS AND, IN FACT, VARY FROM THE DIMENSIONS THAT WOULD BE DETERMINED BY THE DIMENSIONS SET FORTH IN THE DECLARATION (WHICH GENERALLY ONLY INCLUDES THE INTERIOR AIRSPACE BETWEEN THE PERIMETER FINISHES). ADDITIONALLY, MEASUREMENTS OF ROOMS SET FORTH ON ANY FLOOR PLAN ARE GENERALLY TAKEN AT THE POINT OF THE ROOM WHERE A PERFECT RECTANGLE, WITHOUT REGARD FOR ANY CUT OUTS. ACCORDINGLY, THE AREA OF THE ACTUAL ROOM CANNOT BE DETERMINED BY MULTIPLYING THE STATED LENGTH TIMES THE WIDTH. ALL DIMENSIONS ARE APPROXIMATE AND ALL FLOOR PLANS ARE FOR REPRESENTATION ONLY AND SHOULD NOT BE RELIED UPON TO CORRECTLY STATE THE REPRESENTATIONS OF THE DEVELOPER. ALL DIMENSIONS ARE APPROXIMATE AND ALL FLOOR PLANS ARE FOR REPRESENTATION ONLY. FEDERAL FAIR HOUSING ACT OF 1968. FOR CORRECT REPRESENTATIONS, MAKE REFERENCE TO THE DOCUMENTS REQUIRED BY FEDERAL LAW AND READ IT CAREFULLY BEFORE ENTERING INTO A CONTRACT TO SELL, OR SOLICITATION OF OFFERS TO BUY THE CONDOMINIUM UNITS WHERE PROHIBITED BY STATE LAW.

